



Diesel Compact Single phase BG10

| | Prime | Standby |
|----------------|-----------|-----------|
| Genset model | EN5-BG10P | EN5-BG10S |
| 220-240V, 50Hz | 6.6kVA | 7.3kVA |
| | 6.6kW | 7.3kW |
| 220/110V, 60Hz | 8.3kVA | 9.2kVA |
| | 8.3kW | 9.2kW |

Ratings at 1.0 pf

Prime:

This rating is for the supply of continuous electrical power (at variable load) in lieu of commercially purchased power. There is no limitation on the annual hours of operation and 10% overload power can be supplied for one hour in twelve hours.

Standby:

This rating is for the supply of continuous electrical power (at variable load) in the event of a utility power failure. No overload is permitted.



| | | |
|---------------------|---------------------|-----------|
| Engine model | Perkins | 403D-11G |
| Number of cylinders | 3 in-line | |
| Cubic capacity | litre (cu inch) | 1.13 (69) |
| Aspiration | Naturally Aspirated | |
| Alternator | European | |



Genset photograph may include optional extras

| Frequency | | 50Hz | 60Hz |
|--|----------------------------|-------------|--------------|
| Engine speed | rpm | 1,500 | 1,800 |
| Fuel tank capacity | litre (USgal) | 100 (26.4) | 100 (26.4) |
| Fuel consumption at full rating: | litre /h (USgal /h) | 2.60 (0.69) | 3.00 (0.79) |
| Prime | | | |
| Standby | litre /h (USgal /h) | 2.90 (0.77) | 3.60 (0.95) |
| Heat rejection to exhaust system (max) | kW (BTU /min) | 8.0 (455) | 10.8 (615) |
| Heat rejection to cooling system (max) | kW (BTU /min) | 9.5 (541) | 12.1 (689) |
| Total radiated heat (max) | kW (BTU /min) | 2.5 (142) | 3.1 (176) |
| Exhaust temperature (max) | deg C (deg F) | 420 (788) | 515 (959) |
| Radiator cooling air flow | cu m /min (cfm) | 26.4 (932) | 35.4 (1,250) |
| with max restriction | mm (inch) H ₂ O | 12.7 (0.50) | 12.7 (0.50) |
| Combustion air flow (max) | cu m /min (cfm) | 0.70 (25) | 0.90 (32) |
| Exhaust gas flow (max) | cu m /min (cfm) | 1.80 (64) | 2.40 (85) |
| with max allowable back pressure | mm (inch) H ₂ O | 1040 (40.9) | 1040 (40.9) |

Note: Standard reference conditions: 25°C (77°F) air inlet temperature, 152.4m (500ft) above sea level, 60% relative humidity. All engine performance data based on the above mentioned maximum continuous ratings. Fuel consumption data at full load for diesel fuel with specific gravity of 0.85 and conforming to BS2869: 1998, class A2.



Burtonwood[™]

Generator & Switchgear Services **Data Sheet EN5-BG10**

| Dimensions: | | |
|---|-----------|--------------|
| Length (A) | mm (inch) | 1,325 (52.2) |
| Width (B) | mm (inch) | 720 (28.3) |
| Height (C) | mm (inch) | 1,155 (45.5) |
| Total height of exhaust rain cap (D) | mm (inch) | NA |
| Max horizontal projection of end door (E) | mm (inch) | NA |
| Max horizontal projection of doors at each side (F) | mm (inch) | NA |

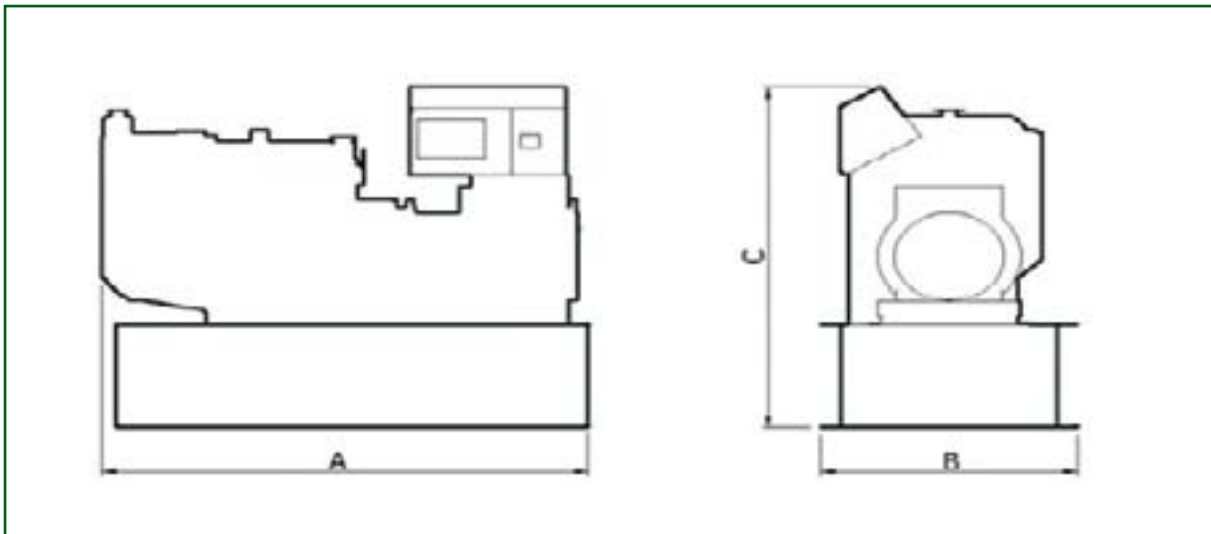

| Weights: | | |
|--|---------|-----------|
| Dry weight (with lube oil) | kg (lb) | 408 (899) |
| Wet weight (with lube oil and coolant) | kg (lb) | 416 (917) |

| Sound pressure levels: | | 50Hz | 60Hz |
|------------------------|-------|---------|---------|
| | | 1500rpm | 1800rpm |
| 15m, 75% load | dB(A) | TBA | TBA |
| 15m, 100% load | dB(A) | TBA | TBA |
| 7m, 75% load | dB(A) | TBA | TBA |
| 7m, 100% load | dB(A) | TBA | TBA |
| 1m, 75% load | dB(A) | TBA | TBA |
| 1m, 100% load | dB(A) | TBA | TBA |

In line with our policy of continuous development, we reserve the right to change specification without notice

EN5-BG10 - DS-324-0311